

ROLL 490

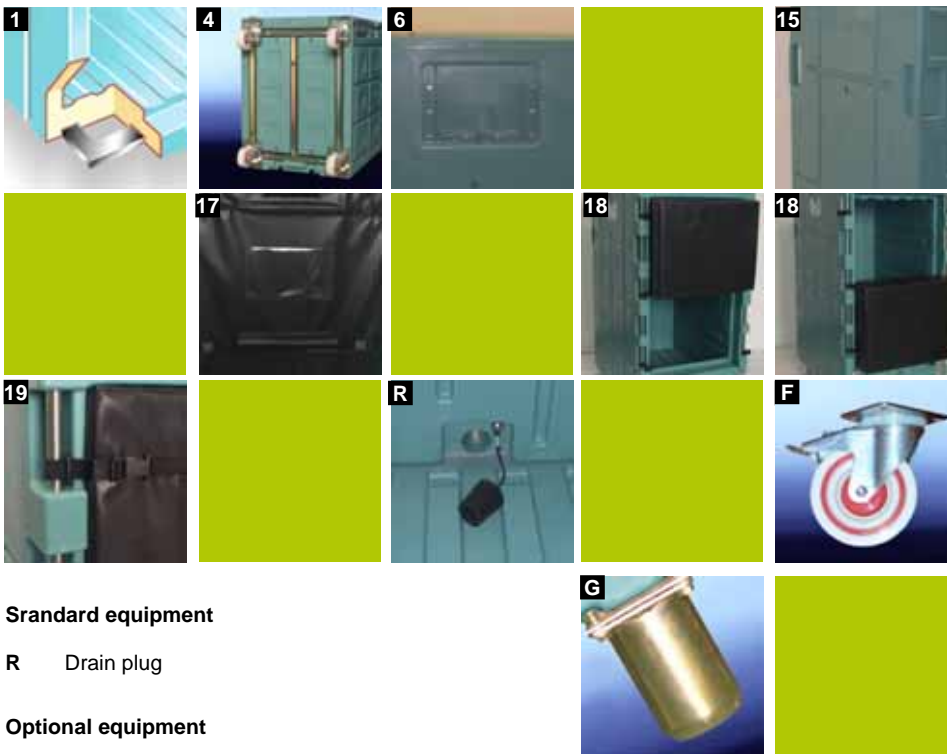

Features	ROLL 490
Outer dimensions in mm	720 W x 1020 D x 1555 H
Inner dimensions in mm	530 W x 800 D x 1168 H
Volume	490 litres
K value	- W/m ² .K
Weight	87 Kg
Insulation material	Expanded polyurethane foam
Material of the walls	Rotomoulded polyethylene

Specifications and optional equipment



Technical features

- 1 Body made of one piece rotomoulded polyethylene. Insulation with CFC free expanded polyurethane foam.
- 4 Rustproof treated steel frame, flush mounted, fitted with 2 fixed and 2 swivelling castors Ø 125 mm
- 6 Label holder on body
- 15 4 flush-mounted handles
- 17 Label holder on door
- 18 Soft door made of 2 folds
- 18 Soft door made of 2 folds
- 19 Closing hook

Standard equipment

R Drain plug

Optional equipment

- F 2 brake wheels Ø 125
- F 4 swivelling wheels Ø 125, 2 with brake
- G 4 metal feet



CO2Air, Inc · Xactics, Inc
Exclusive distributor in Japan

Dryice Service Corporation

595-1 Tonodaicho Wakaba-ku,
Chiba city, Chiba 264-0036, Japan
TEL:+81-43-255-5640 FAX:+81-43-255-8780
E-mail:Shiozaki@dryice-service.co.jp
<http://dryice-service.co.jp/>